

*UriSponge®*

Easy-to-Use System  
For Urine Collection,  
Transport, and  
Preservation



**Copan**  
innovating together



Copan's UriSponge® is an FDA-cleared, advanced urine specimen collection, transport, and preservation system, featuring a screw cap tube with a plastic applicator stick and two cylindrical sponges. Integrated urine preservatives are chemically bonded into the sponge and activate upon contact with urine. This design ensures efficient specimen transport from collection to laboratory while maintaining integrity for accurate uropathogenic bacteria and yeasts cultivation using standard clinical laboratory procedures.



#### **Easy-to-use**

Simply dip into sample cup, close and send to the laboratory for analysis.



#### **No fill line necessary**

Reduces repeat collections due to inaccurate filling of traditional vacuum boric acid tubes.



#### **Safe and reliable**

No hypodermic needle or urine transfer straw needed, eliminating potential injury risk.



#### **Cost effective**

Minimizes expenses and waste by eliminating consumables like needles and transfer straws, and preventing the need for repeat collections due to inaccurate filling.



#### **Automation ready**

Standardized, space-saving tubes optimized for automatic specimen processors.



#### **Boric acid free**

Unique urine preservative formulation is non-hazardous and non-toxic.



## **Efficient Handling & Processing**

UriSponge® enhances efficiency in handling and processing with its versatile and compact design. It supports both automated planting and streaking and manual centrifugation for plating, offering flexibility in laboratory workflows.

**Product Info**



## **Seamless Automation Integration**

UriSponge® enhances the utility of Copan's WASP® Walk-Away Specimen Processor for automating upfront microbiology specimen processing. With capabilities including planting and streaking, Gram slide preparation, and inoculation of enrichment broths, WASP® redefines laboratory efficiency. UriSponge® seamlessly integrates with this automated specimen processing, ensuring a smooth workflow from urine sample collection to processing.

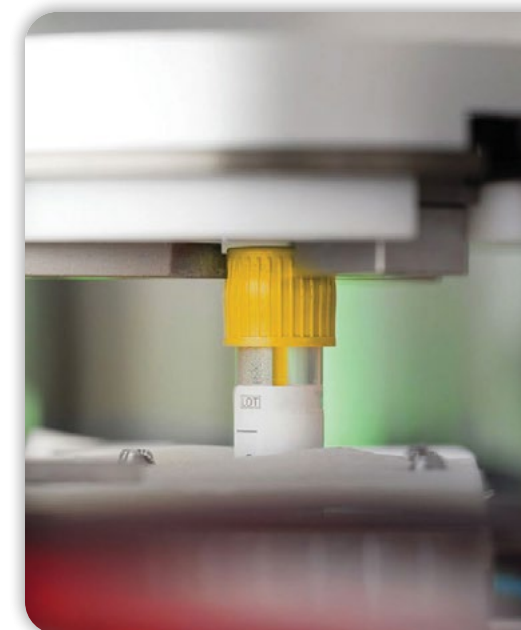

# How to use UriSponge®

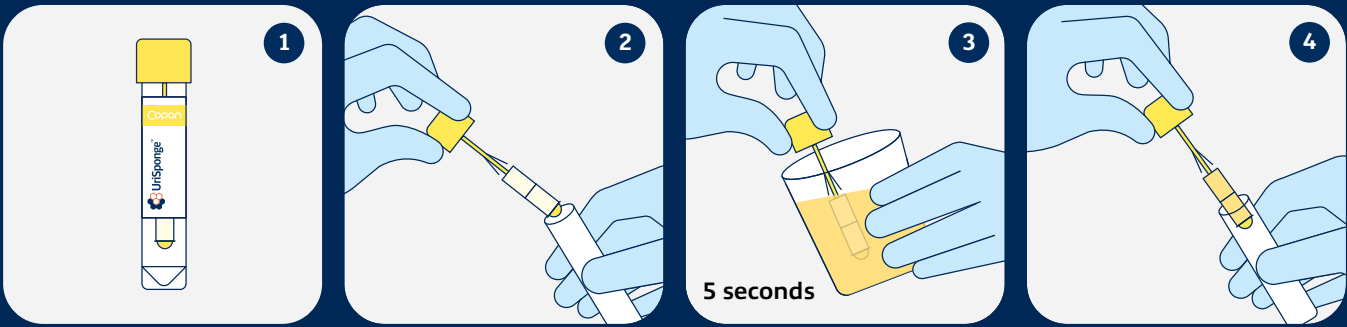

## Ordering information

Cat. No.	Description	Pack size
8U033550	UriSponge® in 12x80 mm tube 	300 pieces (6 boxes of 50 pieces)
	UriSponge® in 16x100 mm tube 	300 pieces (6 boxes of 50 pieces)



These products may not be available in all countries. Please refer to [www.copanusa.com](http://www.copanusa.com) for the most recent version of this document. Always consult product technical documentation for complete information. The use of this product in association with diagnostic kits or instrumentation should be validated by the end user. All trademarks, logos and brand names are the property of their respective owners. ©2025 COPAN Diagnostics Inc. All rights reserved.  
Code:UriSponge\_Brochure\_CD\_04\_2025

[COPANUSA.com](http://COPANUSA.com)   [800.216.4016](tel:800.216.4016)   [@COPANUSA](https://twitter.com/COPANUSA)   [CommunicationsUS@copangroup.com](mailto:CommunicationsUS@copangroup.com)   [/COPAN.USA](https://facebook.com/COPAN.USA)

COPAN Diagnostics, Inc.

26055 Jefferson Avenue | Murrieta, CA 92562 USA