

INSTRUCTIONS FOR NASOPHARYNGEAL SAMPLE COLLECTION USING ESWAB™

COLLECTION SUPPLIES

- Swab (1)
- Tube of medium (1)



This guide is for Illustration Purposes Only. Always read the manufacturer's package insert for specific instructions regarding specimen collection and transport for the type of test kit being used.

COLLECT THE SAMPLE



Wash hands with soap and water and don personal protective equipment.

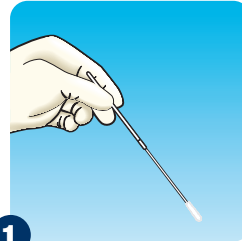

1 Remove the swab from its packaging, holding by the end of the applicator and identify the breaking point.

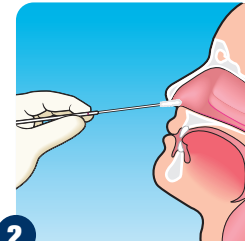

2 Position head slightly back.

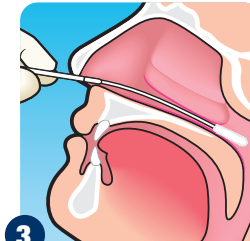

3 Gently insert the swab into the nostril. Keep the swab near the septum floor of the nose while gently pushing the swab into the post nasopharynx.

- As a visual reference, the swab should be inserted about half the distance from the opening of the patient's nostril and the ear.

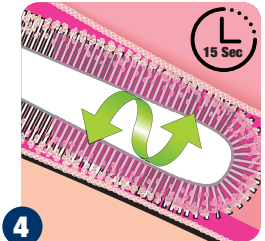

4 When the swab is in place, rotate in a circular motion gently against the nasopharyngeal mucosa for 10 – 15 seconds then gently remove swab.

PACKAGE THE SAMPLE

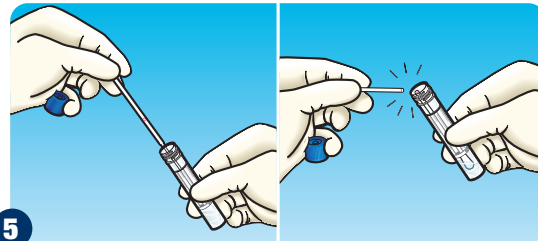

5 While holding the swab, remove the cap from the tube.

- Insert the swab into the tube until the breakpoint is level with the tube opening.
- Bend the swab shaft at a 180 degrees angle to break it off at the breaking point. You may need to gently rotate the swab shaft to complete the breakage.



6 Discard the broken part of the applicator into an approved waste disposal container.

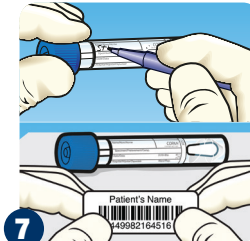

7 Screw the cap back onto the tube and apply patient identification label or write patient information on the tube label.



Wash hands with soap and water.

INSTRUCTIONS FOR NASOPHARYNGEAL SAMPLE COLLECTION USING ESWAB™

COLLECTION SUPPLIES

- Swab (1)
- Tube of medium (1)



COLLECT THE SAMPLE



Wash hands with soap and water and don personal protective equipment.

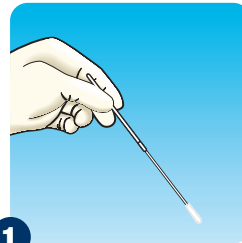

1 Remove the swab from its packaging, holding by the end of the applicator and identify the breaking point.

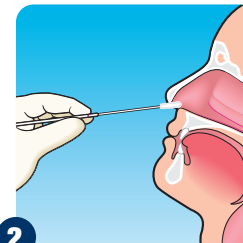

2 Position head slightly back.

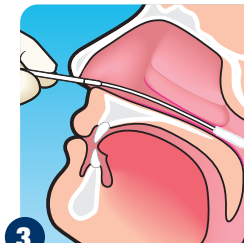

3 Gently insert the swab into the nostril. Keep the swab near the septum floor of the nose while gently pushing the swab into the post nasopharynx.

- As a visual reference, the swab should be inserted about half the distance from the opening of the patient's nostril and the ear.

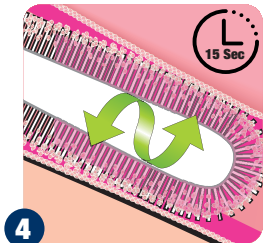

4 When the swab is in place, rotate in a circular motion gently against the nasopharyngeal mucosa for 10 – 15 seconds then gently remove swab.

PACKAGE THE SAMPLE

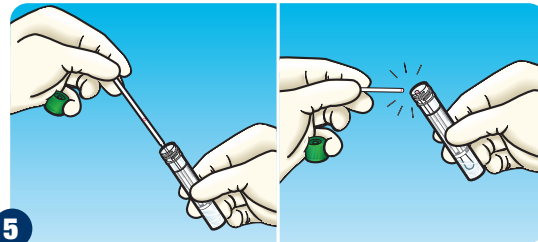

5 While holding the swab, remove the cap from the tube.

- Insert the swab into the tube until the breakpoint is level with the tube opening.
- Bend the swab shaft at a 180 degrees angle to break it off at the breaking point. You may need to gently rotate the swab shaft to complete the breakage.



6 **DISPOSAL**
Discard the broken part of the applicator into an approved waste disposal container.

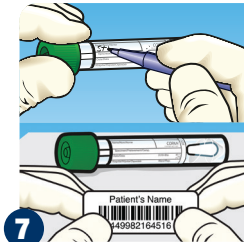

7 Screw the cap back onto the tube and apply patient identification label or write patient information on the tube label.



Wash hands with soap and water.